

## DS-K4H250D Double-Door Magnetic Lock

The magnetic lock is designed for wooden door, glass door, and steel door with the opening angle of 90°. The maximum thrust of the lock is 280 kg (600 Lbs) × 2. It can be used for controlling door opening/closing, and the indicator shows the door status. It supports signal output of door lock output status testing.



### Available Model

DS-K4H250D

### Key Feature

- The magnetic lock supports static linear thrust of 280 kg (600 Lbs) × 2
- The power supply can be customized to be 12 VDC or 24 VDC, and the default voltage is 12 VDC
- It is equipped with internal voltage dependent resistor (MOV)
- It is applied to wooden door, glass door, metal door and fireproof door
- LED indicator displays the status of door lock
- Signal output of door lock status (NO\NC\COM)
- Anti-residual magnetism design
- Abrasion-proof materials
- The shell is made up of aluminum and is hard anodizing electroplated
- No mechanical failure, and the magnetic lock works by electromagnetism force



## Specifications

Model	DS-K4H250D
Dimension of lock body (L × W × H)	480 mm × 49 mm × 25.5 mm (18.90" × 1.93" × 1.00")
Dimension of armature plate (L × W × H)	180 mm × 38 mm × 11 mm (7.1" × 1.5" × 0.4" )
Maximum thrust	280 kg (600 Lbs) × 2 linear thrust
Input voltage	12 VDC/24 VDC
Working current	12 V/500 mA × 2, 24 V/250 mA × 2
Signal Output	Dry contact signal output; Support Maximum power rate of 3A; NO output while locking and NC output while unlocking
LED indicator	Red: Door is unlocked Green: Door is locked
Suitable door	Wooden door, glass door, metal door, fireproof door
Working temperature	-10 °C to 55 °C (14 °F to 131 °F)
Working humidity	0 to 95% (relative humidity)
Shell	Hard anodizing electroplating operated
Lock body	Eco-friendly Zinc with electroplating operated
Armature plate	Eco-friendly Zinc with electroplating operated
Weight	4.2 kg (9.3 Lbs)

Circuit Board Diagram

Lock status sensor

- 1. Normally open switch:NO and COM
- 2. Normally closed switch:NC and COM

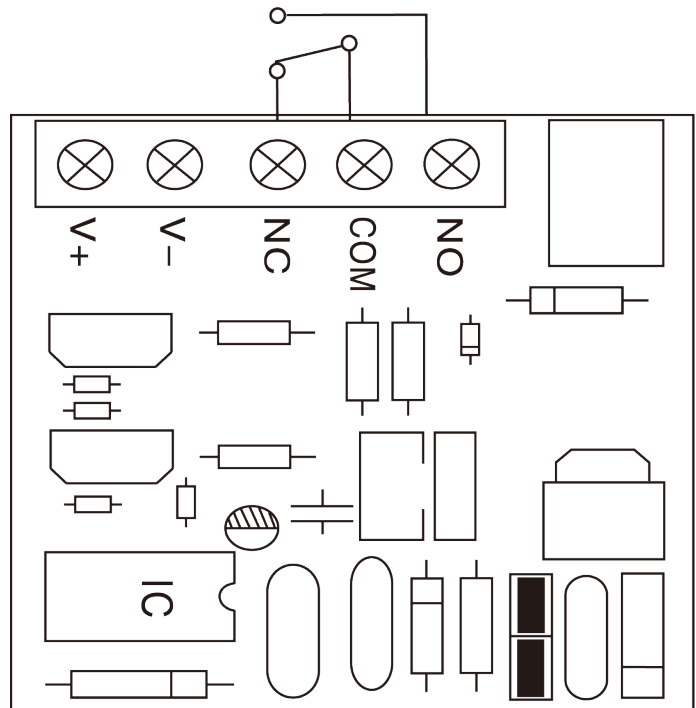

Power selector

Jumper



# Installation

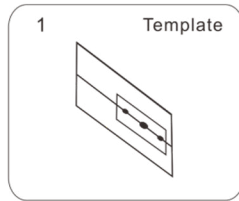
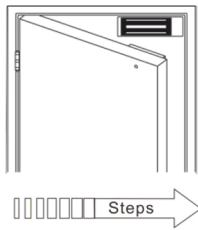

1 Template  
Fold the plate to 90°.

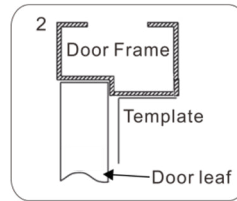

2 Door Frame  
Template  
Door leaf  
Close the door first, then place the upper side of template on door frame, while adjust the left side next to the door leaf.

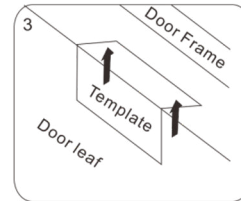

3 Door Frame  
Template  
Door leaf  
Mark screw positions of armature plate and magnetic lock on door leaf and door frame respectively.

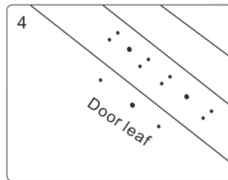

4 Door leaf  
Drill holes based on the marked positions.

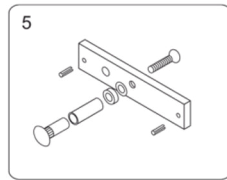

5 Make a combination based on the picture.

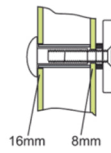

Hollow Metal Door  
Drill a hole  
Inside: Diameter is 8mm  
Outside: Diameter is 16mm

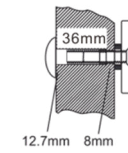

Wooden Door  
Drill a hole  
Inside: Diameter is 8mm  
Outside: Diameter is 12.7mm

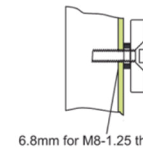

Metal Surface Door  
Inside: Drill a hole diameter is 8mm folding the plastic straight pin

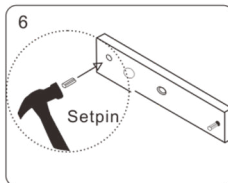

6 Set pin.  
Strike the pin into the armature plate slightly (to avoid movement).

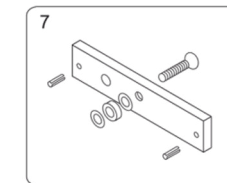

7 Make a combination based on the picture (add washer accordingly). The rubber ring must be added.

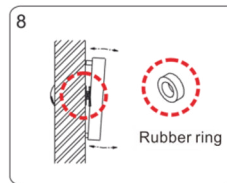

8 Rubber ring  
Place the rubber ring between armature plate and door leaf.

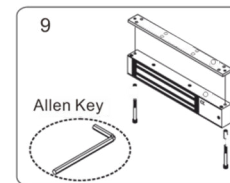

9 Allen Key  
Use Allen key to remove the mounting plate from lock body.

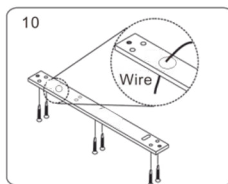

10 Wire  
Fix the mounting plate on the door frame according to the holes drilled earlier.

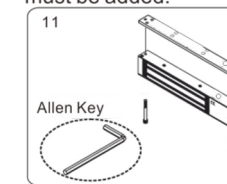

11 Allen Key  
Use Allen key to screw the lock body on the mounting plate.

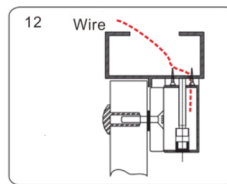

12 Wire  
Close the door to test holding force. The angle between armature plate and magnetic lock can be adjusted by adding or reducing washers.

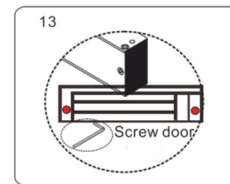

13 Screw door  
After all the appropriate procedures, the holding force can be maximized. Finally, fix the tamper screw.

## Installation Instruction

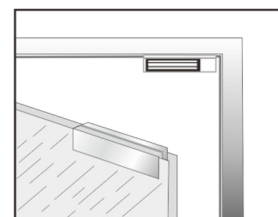
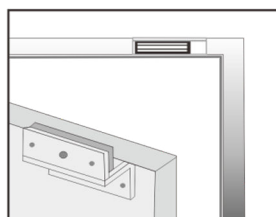
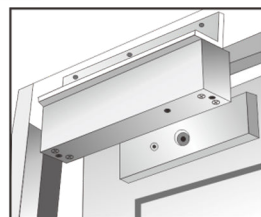
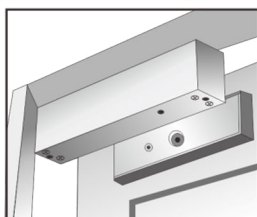



Distributed by

**HIKVISION®****Headquarters**

No.555 Qianmo Road, Binjiang District,  
Hangzhou 310051, China  
T +86-571-8807-5998  
overseasbusiness@hikvision.com

**Hikvision USA**  
T +1-909-895-0400  
sales.usa@hikvision.com

**Hikvision Australia**  
T +61-2-8599-4233  
salesau@hikvision.com

**Hikvision India**  
T +91-22-28469900  
sales@pramahikvision.com

**Hikvision Canada**  
T +1-866-200-6690  
sales.canada@hikvision.com

**Hikvision Thailand**  
T +662-275-9949  
sales.thailand@hikvision.com

**Hikvision Europe**  
T +31-23-5542770  
sales.eu@hikvision.com

**Hikvision Italy**  
T +39-0438-6902  
info.it@hikvision.com

**Hikvision Brazil**  
T +55 11 3318-0050  
Latam.support@hikvision.com

**Hikvision Turkey**  
T +90 [216]521 7070- 7074  
sales.tr@hikvision.com

**Hikvision Malaysia**  
T +601-7652-2413  
sales.my@hikvision.com

**Hikvision UK & Ireland**  
T +01628-902140  
sales.uk@hikvision.com

**Hikvision South Africa**  
Tel: +27 (10) 0351172  
sale.africa@hikvision.com

**Hikvision France**  
T +33(0)1-85-330-450  
info.fr@hikvision.com

**Hikvision Kazakhstan**  
T +7-727-9730667  
nikia.panfilov@hikvision.ru

**Hikvision Vietnam**  
T +84-974270888  
sales.vt@hikvision.com

**Hikvision UAE**  
T +971-4-4432090  
salesme@hikvision.com

**Hikvision Singapore**  
T +65-6684-4718  
sg@hikvision.com

**Hikvision Spain**  
T +34-91-737-16-55  
info.es@hikvision.com

**Hikvision Tashkent**  
T +99-87-1238-9438  
uzb@hikvision.ru

**Hikvision Hong Kong**  
T +852-2151-1761  
info.hk@hikvision.com

**Hikvision Russia**  
T +7-495-669-67-99  
saleru@hikvision.com

**Hikvision Korea**  
T +82-(0)31-731-8817  
sales.korea@hikvision.com

**Hikvision Poland**  
T +48-22-460-01-50  
info.pl@hikvision.com

**Hikvision Indonesia**  
T +62-21-2933759  
Sales.Indonesia@hikvision.com

**Hikvision Colombia**  
sales.colombia@hikvision.com